

West Hardy Road ← Towards Beltway 8

West Hardy Road →

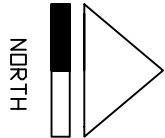
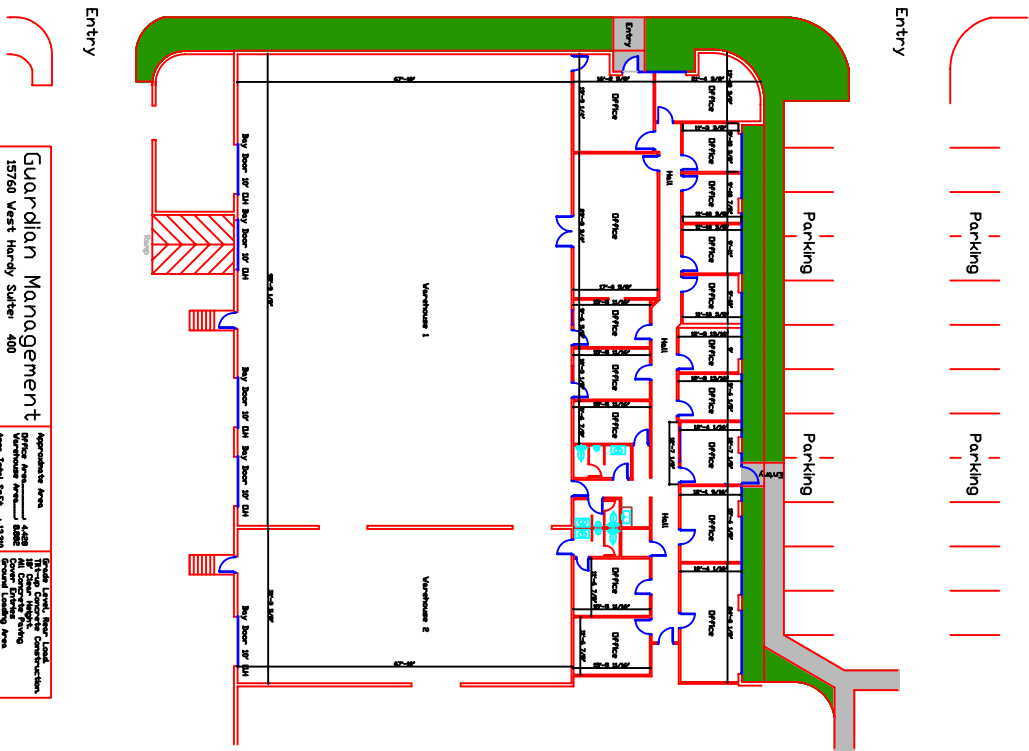

<b>Guardian Management</b>	
15760 West Hardy Street 400	
Approximate Area	4,488
Office Area	8,882
Warehouse Area	13,230
Area Total SQ'FT	22,118
Grade Level	Level
Site Area	10,000
Office Area	8,882
Warehouse Area	13,230
Area Total SQ'FT	22,118